

Notes:

Highways & car park layouts are subject to vehicle tracking used for all detailed planning applications made for each plot.

To be read in conjunction with Civil Eng. current information.

(*A) 'Boardwalk' walk public space with integrated drainage attenuation

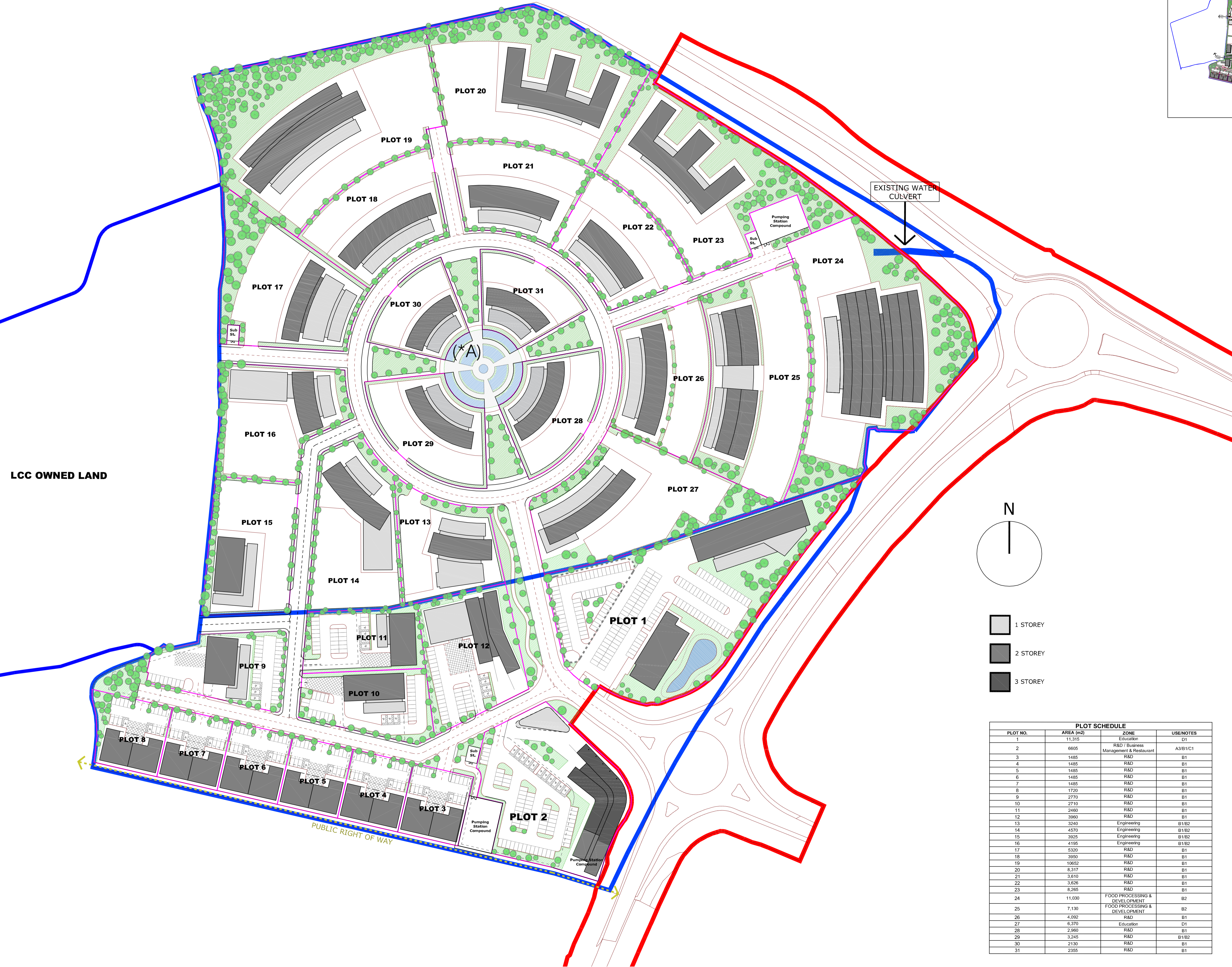

LCC OWNED LAND

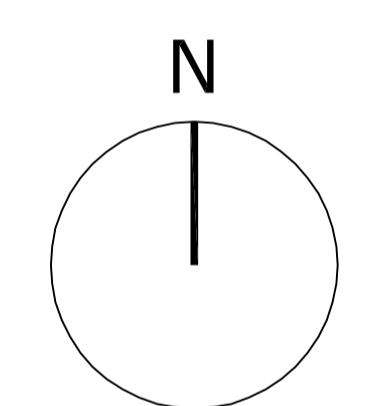

- 1 STOREY
- 2 STOREY
- 3 STOREY

WORK IN PROGRESS

P03	Incorporation of Client's Comments following issue of SK01 & Coordination with Civil Eng.	11.05.17	RJT	RJT
P02	Incorporation of Client's Comments from Steering Group Meeting 08/03/17	17.03.17	RJT	RJT
P01	Revision 1	08.03.17	RJT	RJT
Revision		Date	Drn	Chk

Client
Lincolnshire County Council

Project
**Food Enterprise Zone
Holbeach**

Drawing Title
**Masterplan
WORK IN PROGRESS**

Suitability Status
S2 - Suitable for Information
(S2 - S18 under development or for review & subject to change)

Job No. Scale Site Rev
170262 1:1000 @ A1 P03

Drawing Number
LIN003-PEV-XX-ZZ-DR-A-0002

Project Code - Originator - Zone - Level - Type - Role - Number



T 0345 045 0050 www.pick-everard.co.uk

This drawing is issued for the sole and exclusive use of the intended recipient and is subject to copyright in favour of Pick Everard. Pick Everard does not accept any responsibility or liability whatsoever for its use by a person other than the intended recipient.

PLOT SCHEDULE			
PLOT NO.	AREA (m ²)	ZONE	USENOTES
1	11,315	Education	D1
2	6605	R&D / Business Management & Restaurant	A3/B1/C1
3	1485	R&D	B1
4	1485	R&D	B1
5	1485	R&D	B1
6	1485	R&D	B1
7	1485	R&D	B1
8	1720	R&D	B1
9	2770	R&D	B1
10	2710	R&D	B1
11	2480	R&D	B1
12	3960	R&D	B1
13	3240	Engineering	B1/B2
14	4570	Engineering	B1/B2
15	3925	Engineering	B1/B2
16	4195	Engineering	B1/B2
17	5320	R&D	B1
18	3950	R&D	B1
19	10652	R&D	B1
20	8,317	R&D	B1
21	3,610	R&D	B1
22	3,626	R&D	B1
23	8,265	R&D	B1
24	11,030	FOOD PROCESSING & DEVELOPMENT	B2
25	7,130	FOOD PROCESSING & DEVELOPMENT	B2
26	4,092	R&D	B1
27	6,370	Education	D1
28	2,960	R&D	B1
29	3,245	R&D	B1/B2
30	2130	R&D	B1
31	2355	R&D	B1